

# College of Medicine and Allied Health Sciences Taiba University, Madinah Branch Madinah, Saudi Arabia

---

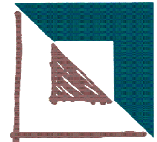

TM Osborn is consultant to the Zuhair Fayeze Partnership, Jeddah, Saudi Arabia, engineers and architects for this new Medical College campus. The engagement encompasses Master Planning for the entire medical campus, plus design consultation and equipment planning for the first phase of the College of Medicine development.

The Master Plan includes over 3 million square feet of educational and medical facility space. The Colleges and the University Teaching Hospital are planned to be developed in several phases over a 10-year period. The six-year Medical College will have classes of 120 students. TM Osborn Associates, Inc. prepared the programming, functional relationship studies, conceptual drawings, and participated in schematic and design development phases of the work.

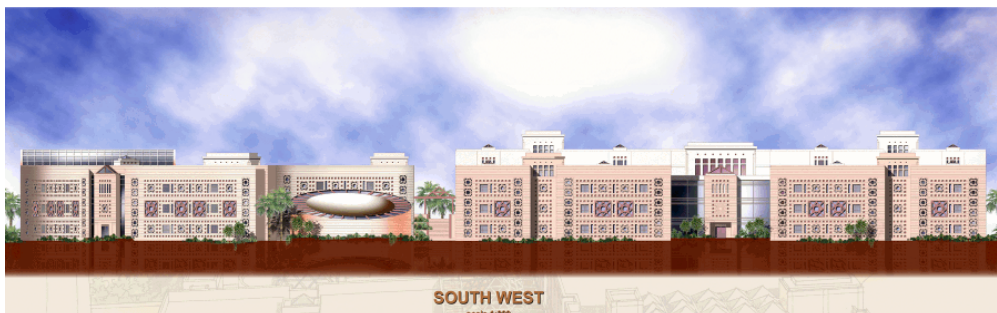
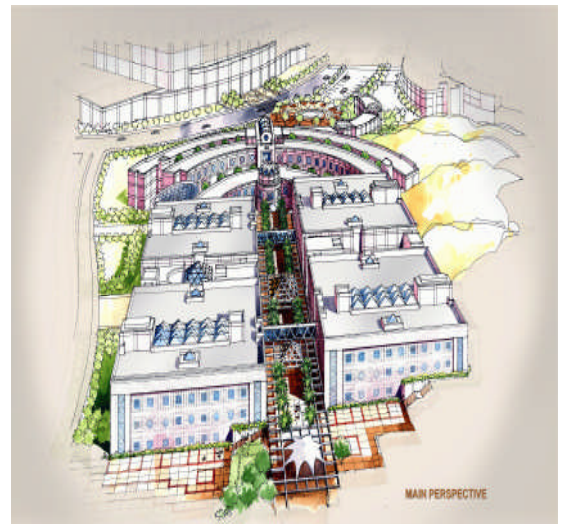

Elements of the Medical Campus include:

- Teaching Hospital of 800 beds
- Primary and Specialty Clinics
- Research Center
- Auditorium / Lecture Halls
- Administration
- College of Medicine, Basic & Clinical Services.
  - Simulation Center
  - Learning Resource Center
  - Student Center
  - Animal Facility
- School of Allied Health Science
- College of Dentistry
- College of Pharmacy
- Service Building and Parking