

# VA Lease-Based Outpatient Clinic Crown Point, Indiana

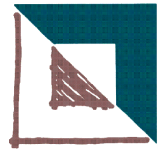

The 20-year old existing leased clinic at Crown Point, Indiana, no longer met the needs for an expanding Veteran patient population. The crowded clinic areas were out of balance with changing practice and increased emphasis on integrated mental health screening and treatment approaches.

TM Osborn, with EBA, Ernest Bland Associates, was engaged to develop the conceptual and technical basis for a new larger (55,000 sf useable) patient friendly leased based clinic building. Site studies considered the placement of the clinic structure in relationship to the VA's previously selected site.

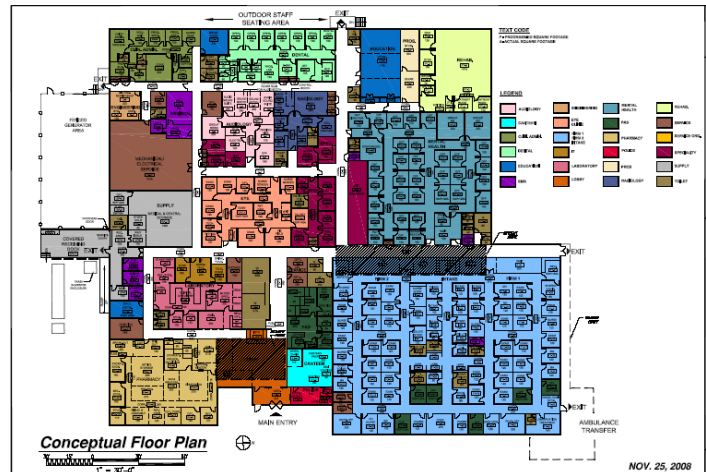

As Healthcare Facility Planning Consultant, TM Osborn developed the space program, departmental adjacencies, conceptual layout of departments, and coordinated the equipment and technical requirements for inclusions in the Statement for Offering. The layout emphasized convenience to patients who required in-and-out encounters for Pharmacy and Laboratory, while way-finding was simplified by a sky-lighted central clinic concourse. Views to the natural setting outdoors are provided from the western and southern facing waiting areas. Zoning of enhanced administrative, staff and service areas added to the clinic's operational efficiency.

